

CONTRACTOR TIP

BY MR. COREY ZUSSMAN OF PEPPER CONSTRUCTION

Discs are typically used for installation when installing mechanically fastened air/vapor barriers, depending on the construction type.

When placing discs at the tape line or joint, ensure the disc gets encased in tape or sealant to confirm an air-tight installation.

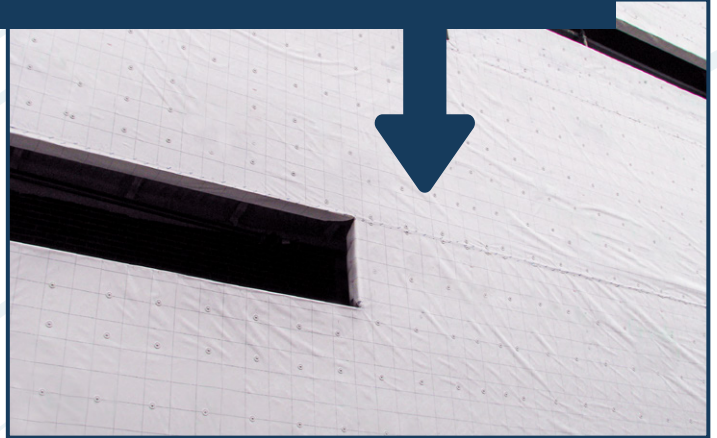
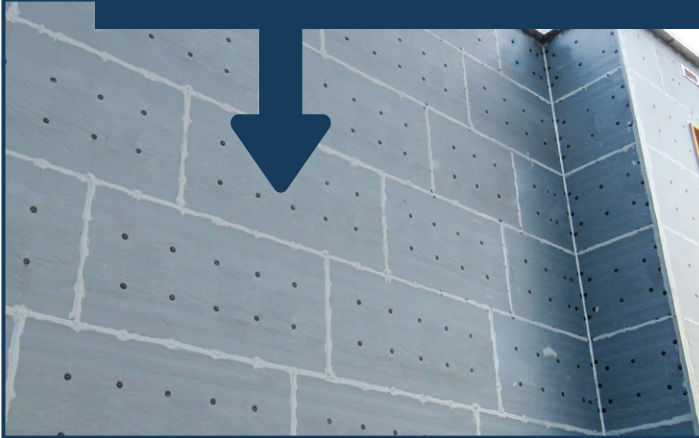

The overlapping of the sheet system and the location of the attachment discs need to be coordinated – air will get under the tape at the discs in these cases because of a lack of tape seal at and adjacent to the disc.

When installing discs adjacent to one another, be careful not to overlap; otherwise, there will be an air passage at the overlap, and the two discs need to be encased in sealant.

