

DENSDEFY™ LIQUID BARRIER SYSTEM **WALL TO FLOOR - DENSDEFY® LIQUID FLASHING**

GP GYPSUM LLC
133 PEACHTREE ST NE
ATLANTA, GA 30303
TOLL FREE: 1-800-225-6119
www.densdefy.com

Detail Notes:

1. Apply DensDefy™ Liquid Barrier so that a minimum 14 wet mils are achieved. Some gypsum sheathing products, OSB and CMU may require additional material and multiple passes to achieve the desired mil thickness and an application free of pinholes and voids.
2. DensDefy® Liquid Flashing may be applied over or under the DensDefy™ Liquid Barrier. Overlap DensDefy™ materials approximately 1" to maintain air- and water-resistive barrier continuity.
3. Refer to DensElement® Barrier System Installation Guide for installation requirements.

MANUFACTURER NOTES

- Refer to the DensDefy™ Liquid Barrier System Installation Guide for surface preparation and installation requirements.

THIS DRAWING IS FOR GENERAL INFORMATION AND GUIDANCE AND INTENDED SOLELY FOR USE BY ARCHITECTS, ENGINEERS AND OTHER PROFESSIONALS FOR PLANNING PURPOSES. THIS DRAWING MAY NOT BE APPROPRIATE FOR ALL PROJECTS, ASSEMBLIES, SYSTEMS OR CONDITIONS, AND IN NO EVENT SHALL THIS DRAWING BE USED FOR CONSTRUCTION. ULTIMATELY, THE DESIGN AND DETAILING OF THE PROJECT, ASSEMBLY OR SYSTEM IS THE RESPONSIBILITY OF A PROFESSIONAL, AND ALL PROJECTS MUST COMPLY WITH APPLICABLE BUILDING CODES AND STANDARDS. GP GYPSUM DISCLAIMS ANY RESPONSIBILITY OR LIABILITY FOR THE USE OF THIS DRAWING AND FOR THE ARCHITECTURE, DESIGN, ENGINEERING OR WORKMANSHIP OF ANY PROJECT, ASSEMBLY OR SYSTEM. ANY PRODUCTS MANUFACTURED BY PERSONS OTHER THAN GEORGIA-PACIFIC GYPSUM ARE PRESENTED FOR ILLUSTRATION ONLY. PLEASE CONTACT THE MANUFACTURER OF SUCH PRODUCTS FOR INSTALLATION INSTRUCTIONS. GP GYPSUM MAKES NO REPRESENTATION OR WARRANTY, EXPRESS OR IMPLIED, CONCERNING THIS DRAWING AND SPECIFICALLY DISCLAIMS ANY IMPLIED WARRANTY OF FITNESS FOR A PARTICULAR USE.

Issued Date 10/16/2020

DLB-032

GP GYPSUM LLC
133 PEACHTREE ST NE
ATLANTA, GA 30303
TOLL FREE: 1-800-225-6119
www.densdefy.com

Detail Notes:

1. Apply DensDefy™ Liquid Barrier so that a minimum 14 wet mils are achieved. Some gypsum sheathing products, OSB and CMU may require additional material and multiple passes to achieve the desired mil thickness and an application free of pinholes and voids.
2. DensDefy® Liquid Flashing may be applied over or under the DensDefy™ Liquid Barrier. Overlap DensDefy™ materials approximately 1" to maintain air- and water-resistive barrier continuity.
3. DensDefy® Transition Membrane must be installed directly to the substrate. Treat all edges with DensDefy® Liquid Flashing and apply DensDefy™ Liquid Barrier approximately 1" over the DensDefy® Liquid Flashing.
4. Refer to DensElement® Barrier System Installation Guide for installation requirements.

MANUFACTURER NOTES

- Refer to the DensDefy™ Liquid Barrier System Installation Guide for surface preparation and installation requirements.

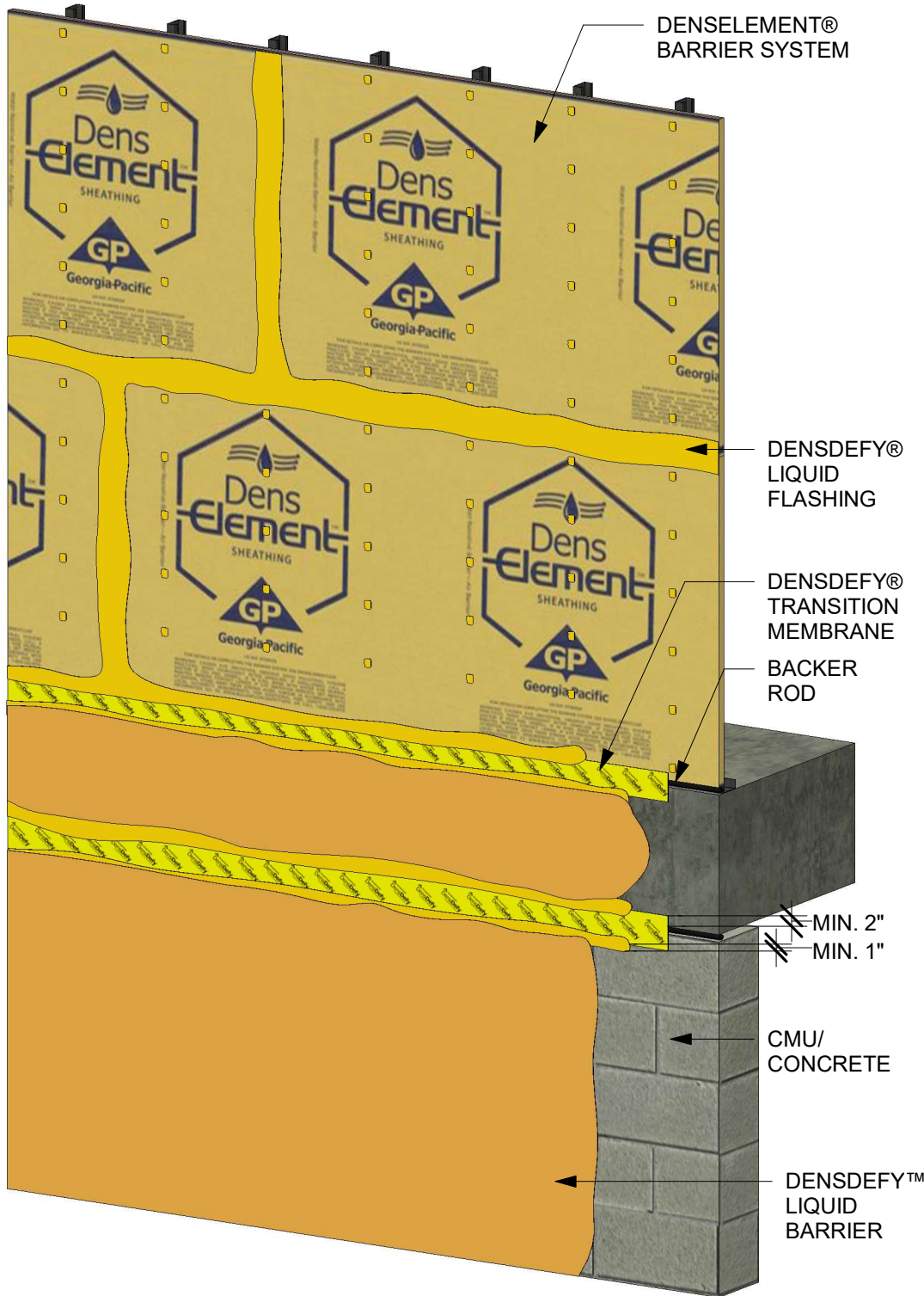

DENSDEFY™ LIQUID BARRIER SYSTEM

WALL TO FLOOR - DENSDEFY® TRANSITION MEMBRANE

THIS DRAWING IS FOR GENERAL INFORMATION AND GUIDANCE AND INTENDED SOLELY FOR USE BY ARCHITECTS, ENGINEERS AND OTHER PROFESSIONALS FOR PLANNING PURPOSES. THIS DRAWING MAY NOT BE APPROPRIATE FOR ALL PROJECTS, ASSEMBLIES, SYSTEMS OR CONDITIONS, AND IN NO EVENT SHALL THIS DRAWING BE USED FOR CONSTRUCTION. ULTIMATELY, THE DESIGN AND DETAILING OF THE PROJECT, ASSEMBLY OR SYSTEM IS THE RESPONSIBILITY OF A PROFESSIONAL, AND ALL PROJECTS MUST COMPLY WITH APPLICABLE BUILDING CODES AND STANDARDS. GP GYPSUM DISCLAIMS ANY RESPONSIBILITY OR LIABILITY FOR THE USE OF THIS DRAWING AND FOR THE ARCHITECTURE, DESIGN, ENGINEERING OR WORKMANSHIP OF ANY PROJECT, ASSEMBLY OR SYSTEM. ANY PRODUCTS MANUFACTURED BY PERSONS OTHER THAN GEORGIA-PACIFIC GYPSUM ARE PRESENTED FOR ILLUSTRATION ONLY. PLEASE CONTACT THE MANUFACTURER OF SUCH PRODUCTS FOR INSTALLATION INSTRUCTIONS. GP GYPSUM MAKES NO REPRESENTATION OR WARRANTY, EXPRESS OR IMPLIED, CONCERNING THIS DRAWING AND SPECIFICALLY DISCLAIMS ANY IMPLIED WARRANTY OF FITNESS FOR A PARTICULAR USE.

Issued Date 10/16/2020

DLB-032.1

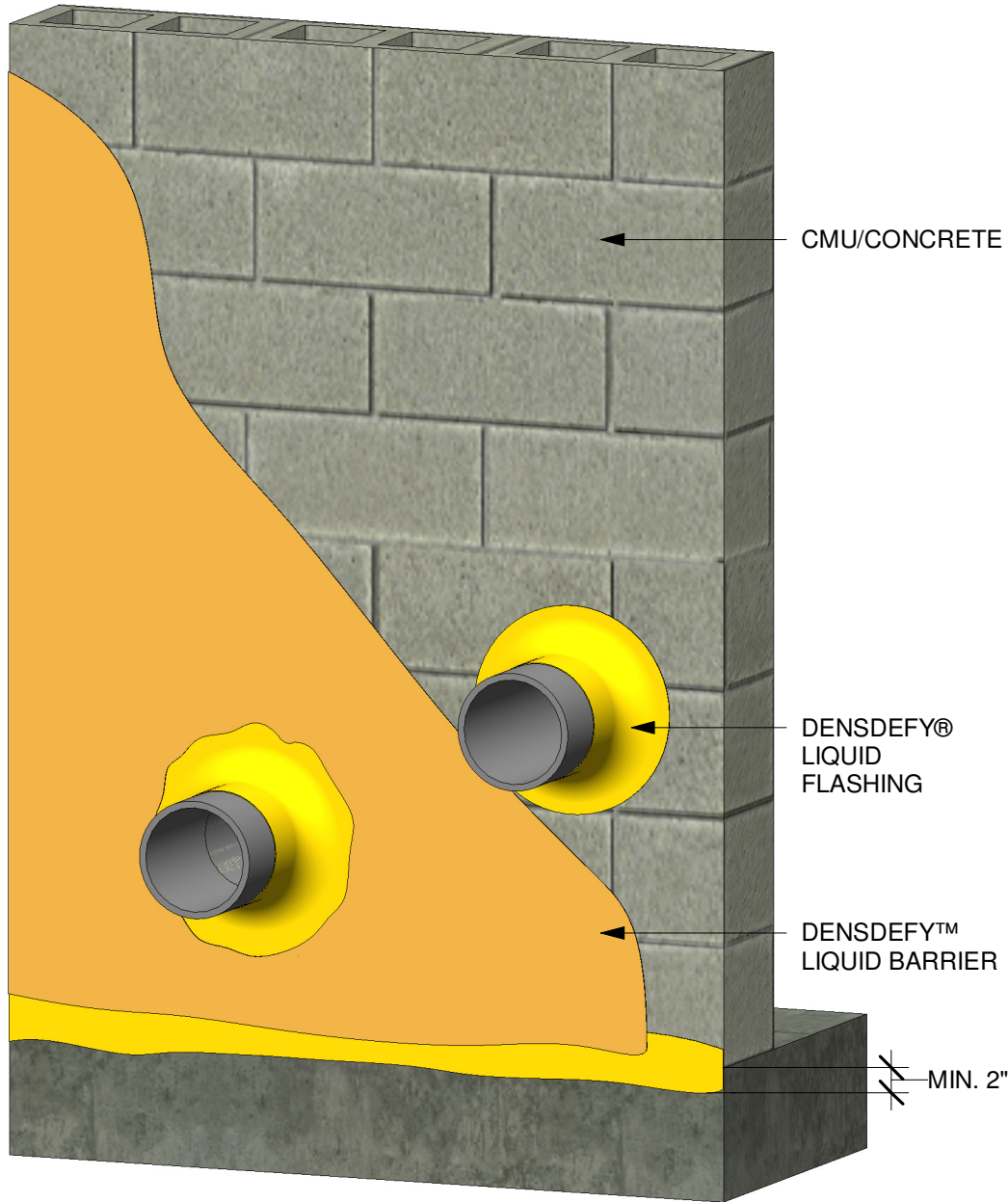

Detail Notes:

1. Apply DensDefy™ Liquid Barrier so that a minimum 14 wet mils are achieved. Some gypsum sheathing products, OSB and CMU may require additional material and multiple passes to achieve the desired mil thickness and an application free of pinholes and voids.
2. DensDefy® Liquid Flashing may be applied over or under the DensDefy™ Liquid Barrier. Overlap DensDefy™ materials approximately 1" to maintain air- and water-resistive barrier continuity.

MANUFACTURER NOTES

- Refer to the DensDefy™ Liquid Barrier System Installation Guide for surface preparation and installation requirements.

DENSDEFY™ LIQUID BARRIER SYSTEM PENETRATION

THIS DRAWING IS FOR GENERAL INFORMATION AND GUIDANCE AND INTENDED SOLELY FOR USE BY ARCHITECTS, ENGINEERS AND OTHER PROFESSIONALS FOR PLANNING PURPOSES. THIS DRAWING MAY NOT BE APPROPRIATE FOR ALL PROJECTS, ASSEMBLIES, SYSTEMS OR CONDITIONS, AND IN NO EVENT SHALL THIS DRAWING BE USED FOR CONSTRUCTION. ULTIMATELY, THE DESIGN AND DETAILING OF THE PROJECT, ASSEMBLY OR SYSTEM IS THE RESPONSIBILITY OF A PROFESSIONAL, AND ALL PROJECTS MUST COMPLY WITH APPLICABLE BUILDING CODES AND STANDARDS. GP GYPSUM DISCLAIMS ANY RESPONSIBILITY OR LIABILITY FOR THE USE OF THIS DRAWING AND FOR THE ARCHITECTURE, DESIGN, ENGINEERING OR WORKMANSHIP OF ANY PROJECT, ASSEMBLY OR SYSTEM. ANY PRODUCTS MANUFACTURED BY PERSONS OTHER THAN GEORGIA-PACIFIC GYPSUM ARE PRESENTED FOR ILLUSTRATION ONLY. PLEASE CONTACT THE MANUFACTURER OF SUCH PRODUCTS FOR INSTALLATION INSTRUCTIONS. GP GYPSUM MAKES NO REPRESENTATION OR WARRANTY, EXPRESS OR IMPLIED, CONCERNING THIS DRAWING AND SPECIFICALLY DISCLAIMS ANY IMPLIED WARRANTY OF FITNESS FOR A PARTICULAR USE.

Issued Date

10/16/2020

DLB-040

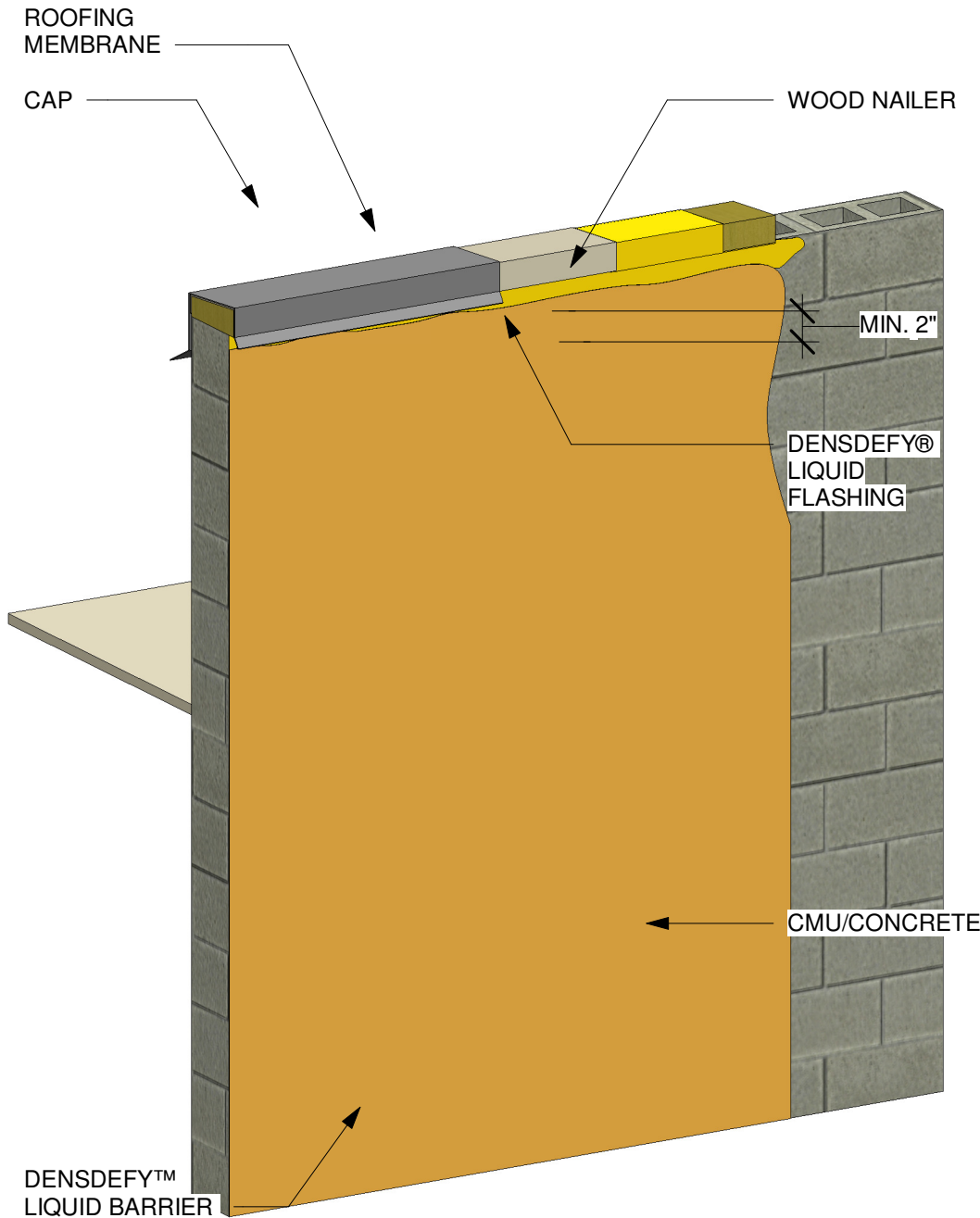

Detail Notes:

1. Apply DensDefy™ Liquid Barrier so that a minimum 14 wet mils are achieved. Some gypsum sheathing products, OSB and CMU may require additional material and multiple passes to achieve the desired mil thickness and an application free of pinholes and voids.
2. DensDefy® Liquid Flashing may be applied over or under the DensDefy™ Liquid Barrier. Overlap DensDefy™ materials approximately 1" to maintain air- and water-resistive barrier continuity.

MANUFACTURER NOTES

- Refer to the DensDefy™ Liquid Barrier System Installation Guide for surface preparation and installation requirements.

DENSDEFY™ LIQUID BARRIER SYSTEM PARAPET - DENSDEFY® LIQUID FLASHING

THIS DRAWING IS FOR GENERAL INFORMATION AND GUIDANCE AND INTENDED SOLELY FOR USE BY ARCHITECTS, ENGINEERS AND OTHER PROFESSIONALS FOR PLANNING PURPOSES. THIS DRAWING MAY NOT BE APPROPRIATE FOR ALL PROJECTS, ASSEMBLIES, SYSTEMS OR CONDITIONS, AND IN NO EVENT SHALL THIS DRAWING BE USED FOR CONSTRUCTION. ULTIMATELY, THE DESIGN AND DETAILING OF THE PROJECT, ASSEMBLY OR SYSTEM IS THE RESPONSIBILITY OF A PROFESSIONAL, AND ALL PROJECTS MUST COMPLY WITH APPLICABLE BUILDING CODES AND STANDARDS. GP GYPSUM DISCLAIMS ANY RESPONSIBILITY OR LIABILITY FOR THE USE OF THIS DRAWING AND FOR THE ARCHITECTURE, DESIGN, ENGINEERING OR WORKMANSHIP OF ANY PROJECT, ASSEMBLY OR SYSTEM. ANY PRODUCTS MANUFACTURED BY PERSONS OTHER THAN GEORGIA-PACIFIC GYPSUM ARE PRESENTED FOR ILLUSTRATION ONLY. PLEASE CONTACT THE MANUFACTURER OF SUCH PRODUCTS FOR INSTALLATION INSTRUCTIONS. GP GYPSUM MAKES NO REPRESENTATION OR WARRANTY, EXPRESS OR IMPLIED, CONCERNING THIS DRAWING AND SPECIFICALLY DISCLAIMS ANY IMPLIED WARRANTY OF FITNESS FOR A PARTICULAR USE.

Issued Date

10/16/2020

DLB-050

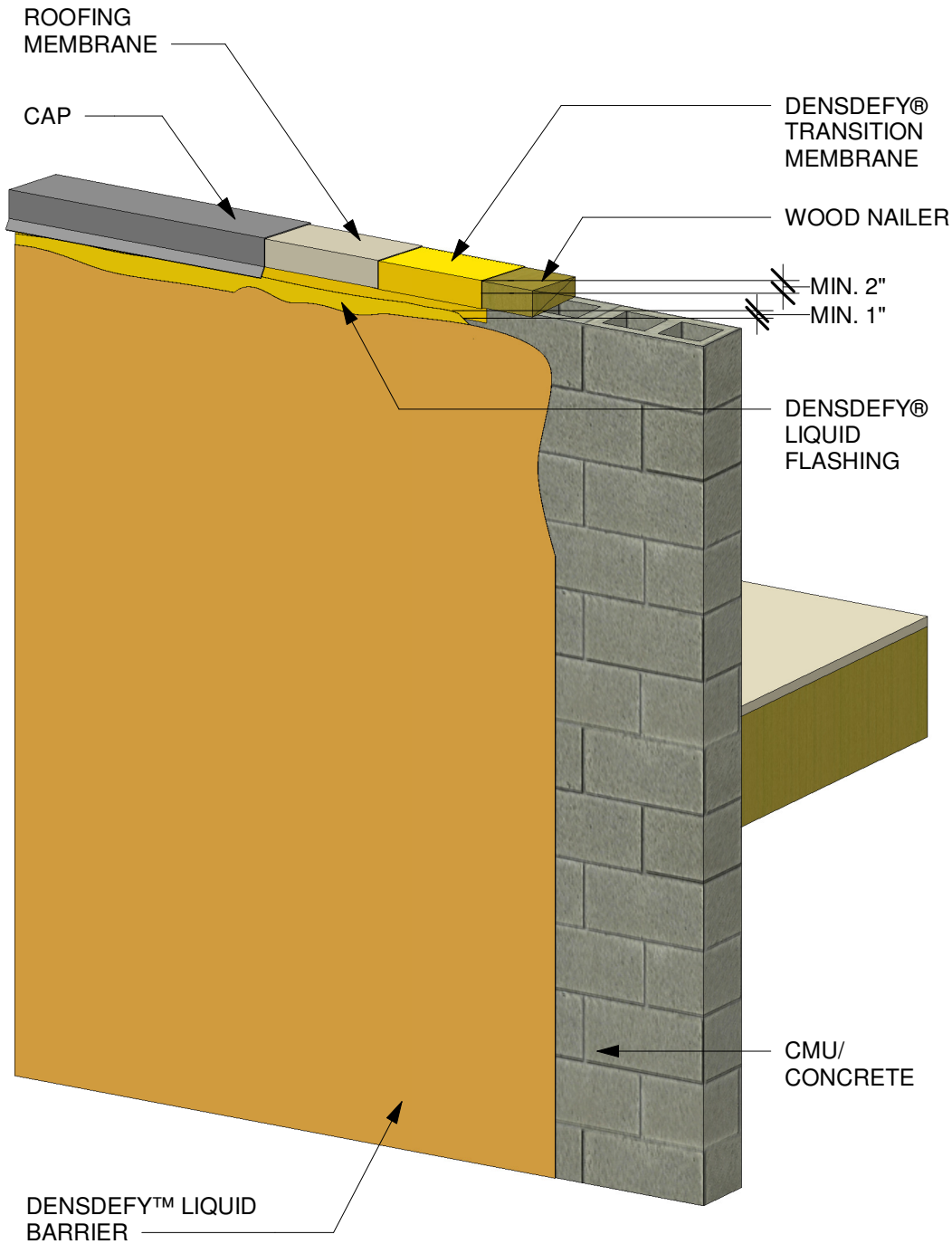

Detail Notes:

1. Apply DensDefy™ Liquid Barrier so that a minimum 14 wet mils are achieved. Some gypsum sheathing products, OSB and CMU may require additional material and multiple passes to achieve the desired mil thickness and an application free of pinholes and voids.
2. DensDefy® Liquid Flashing may be applied over or under the DensDefy™ Liquid Barrier. Overlap DensDefy™ materials approximately 1" to maintain air- and water-resistive barrier continuity.
3. DensDefy® Transition Membrane must be installed directly to the substrate. Treat all edges with DensDefy® Liquid Flashing and apply DensDefy™ Liquid Barrier approximately 1" over the DensDefy® Liquid Flashing.

MANUFACTURER NOTES

- Refer to the DensDefy™ Liquid Barrier System Installation Guide for surface preparation and installation requirements.

DENSDEFY™ LIQUID BARRIER SYSTEM PARAPET - DENSDEFY® TRANSITION MEMBRANE

THIS DRAWING IS FOR GENERAL INFORMATION AND GUIDANCE AND INTENDED SOLELY FOR USE BY ARCHITECTS, ENGINEERS AND OTHER PROFESSIONALS FOR PLANNING PURPOSES. THIS DRAWING MAY NOT BE APPROPRIATE FOR ALL PROJECTS, ASSEMBLIES, SYSTEMS OR CONDITIONS, AND IN NO EVENT SHALL THIS DRAWING BE USED FOR CONSTRUCTION. ULTIMATELY, THE DESIGN AND DETAILING OF THE PROJECT, ASSEMBLY OR SYSTEM IS THE RESPONSIBILITY OF A PROFESSIONAL, AND ALL PROJECTS MUST COMPLY WITH APPLICABLE BUILDING CODES AND STANDARDS. GP GYPSUM DISCLAIMS ANY RESPONSIBILITY OR LIABILITY FOR THE USE OF THIS DRAWING AND FOR THE ARCHITECTURE, DESIGN, ENGINEERING OR WORKMANSHIP OF ANY PROJECT, ASSEMBLY OR SYSTEM. ANY PRODUCTS MANUFACTURED BY PERSONS OTHER THAN GEORGIA-PACIFIC GYPSUM ARE PRESENTED FOR ILLUSTRATION ONLY. PLEASE CONTACT THE MANUFACTURER OF SUCH PRODUCTS FOR INSTALLATION INSTRUCTIONS. GP GYPSUM MAKES NO REPRESENTATION OR WARRANTY, EXPRESS OR IMPLIED, CONCERNING THIS DRAWING AND SPECIFICALLY DISCLAIMS ANY IMPLIED WARRANTY OF FITNESS FOR A PARTICULAR USE.

Issued Date	10/16/2020
-------------	------------

DLB-050.1

GP GYPSUM LLC
133 PEACHTREE ST NE
ATLANTA, GA 30303
TOLL FREE: 1-800-225-6119
www.densdefy.com

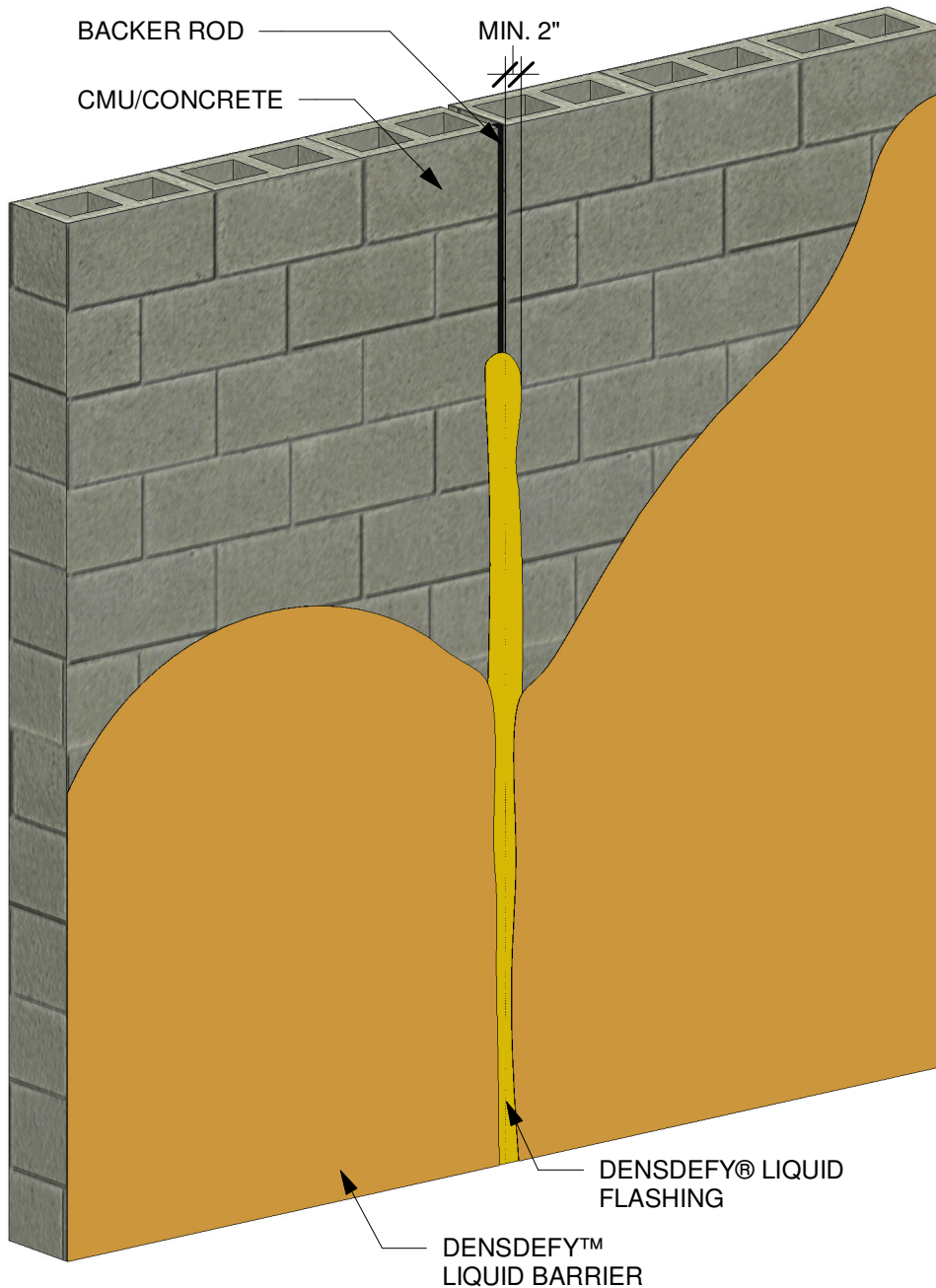

Detail Notes:

1. Apply DensDefy™ Liquid Barrier so that a minimum 14 wet mils are achieved. Some gypsum sheathing products, OSB and CMU may require additional material and multiple passes to achieve the desired mil thickness and an application free of pinholes and voids.
2. DensDefy® Liquid Flashing may be applied over or under the DensDefy™ Liquid Barrier. Overlap DensDefy™ materials approximately 1" to maintain air- and water-resistive barrier continuity.

MANUFACTURER NOTES

- Refer to the DensDefy™ Liquid Barrier System Installation Guide for surface preparation and installation requirements.

DENSDEFY™ LIQUID BARRIER SYSTEM CONTROL JOINT DENSDEFY® LIQUID FLASHING

THIS DRAWING IS FOR GENERAL INFORMATION AND GUIDANCE AND INTENDED SOLELY FOR USE BY ARCHITECTS, ENGINEERS AND OTHER PROFESSIONALS FOR PLANNING PURPOSES. THIS DRAWING MAY NOT BE APPROPRIATE FOR ALL PROJECTS, ASSEMBLIES, SYSTEMS OR CONDITIONS, AND IN NO EVENT SHALL THIS DRAWING BE USED FOR CONSTRUCTION. ULTIMATELY, THE DESIGN AND DETAILING OF THE PROJECT, ASSEMBLY OR SYSTEM IS THE RESPONSIBILITY OF A PROFESSIONAL, AND ALL PROJECTS MUST COMPLY WITH APPLICABLE BUILDING CODES AND STANDARDS. GP GYPSUM DISCLAIMS ANY RESPONSIBILITY OR LIABILITY FOR THE USE OF THIS DRAWING AND FOR THE ARCHITECTURE, DESIGN, ENGINEERING OR WORKMANSHIP OF ANY PROJECT, ASSEMBLY OR SYSTEM. ANY PRODUCTS MANUFACTURED BY PERSONS OTHER THAN GEORGIA-PACIFIC GYPSUM ARE PRESENTED FOR ILLUSTRATION ONLY. PLEASE CONTACT THE MANUFACTURER OF SUCH PRODUCTS FOR INSTALLATION INSTRUCTIONS. GP GYPSUM MAKES NO REPRESENTATION OR WARRANTY, EXPRESS OR IMPLIED, CONCERNING THIS DRAWING AND SPECIFICALLY DISCLAIMS ANY IMPLIED WARRANTY OF FITNESS FOR A PARTICULAR USE.

©2021 GP GYPSUM LLC. ALL RIGHTS RESERVED. UNLESS OTHERWISE NOTED ALL TRADEMARKS ARE OWNED BY OR LICENSED TO GP GYPSUM

Issued Date

10/16/2020

DLB-060

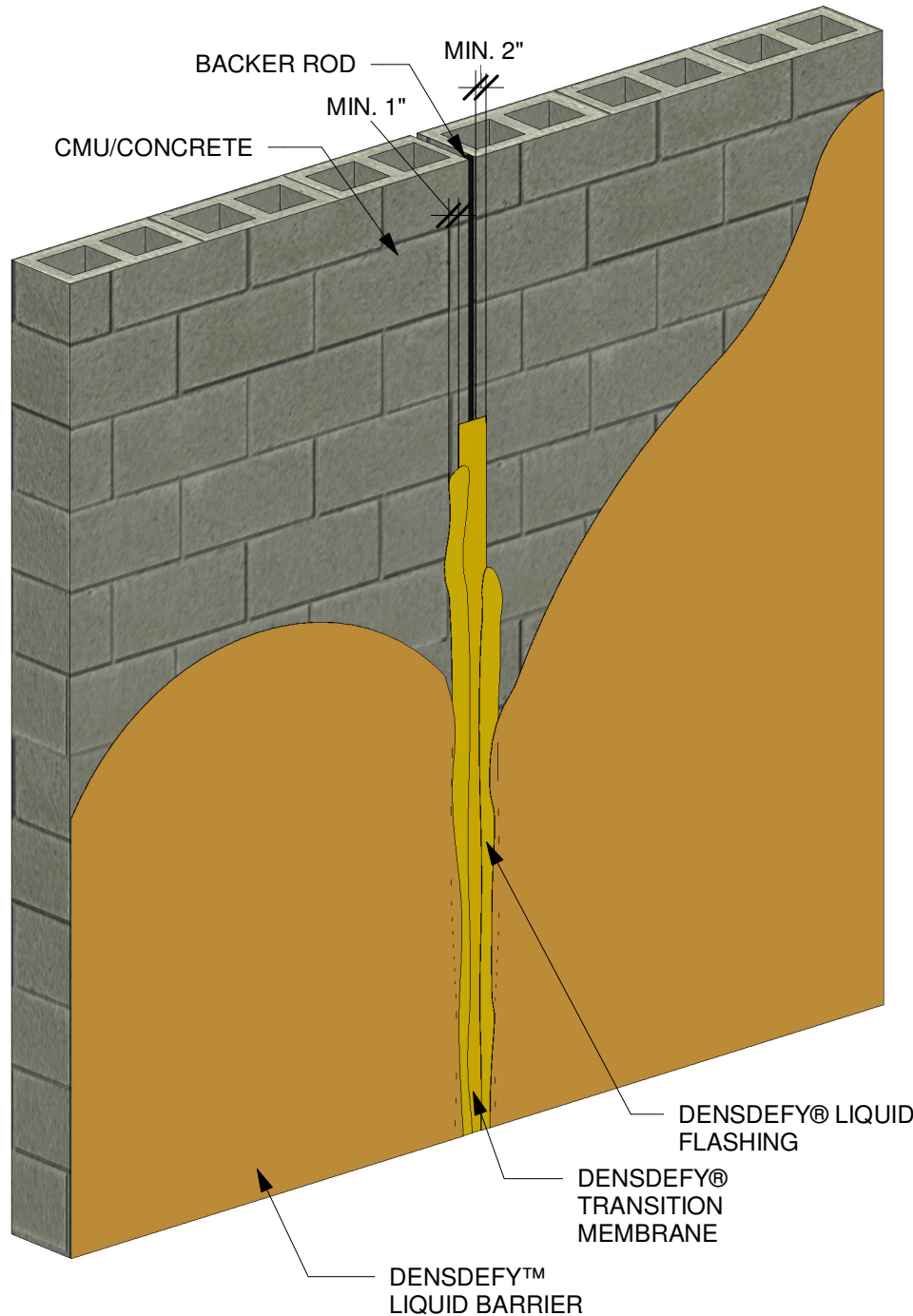

DENSDEFY™ LIQUID BARRIER SYSTEM

CONTROL JOINT DENSDEFY® TRANSITION MEMBRANE

Detail Notes:

1. Apply DensDefy™ Liquid Barrier so that a minimum 14 wet mils are achieved. Some gypsum sheathing products, OSB and CMU may require additional material and multiple passes to achieve the desired mil thickness and an application free of pinholes and voids.
2. DensDefy® Liquid Flashing may be applied over or under the DensDefy™ Liquid Barrier. Overlap DensDefy™ materials approximately 1" to maintain air- and water-resistive barrier continuity.
3. DensDefy® Transition Membrane must be installed directly to the substrate. Treat all edges with DensDefy® Liquid Flashing and apply DensDefy™ Liquid Barrier approximately 1" over the DensDefy® Liquid Flashing.

MANUFACTURER NOTES

- Refer to the DensDefy™ Liquid Barrier System Installation Guide for surface preparation and installation requirements.

THIS DRAWING IS FOR GENERAL INFORMATION AND GUIDANCE AND INTENDED SOLELY FOR USE BY ARCHITECTS, ENGINEERS AND OTHER PROFESSIONALS FOR PLANNING PURPOSES. THIS DRAWING MAY NOT BE APPROPRIATE FOR ALL PROJECTS, ASSEMBLIES, SYSTEMS OR CONDITIONS, AND IN NO EVENT SHALL THIS DRAWING BE USED FOR CONSTRUCTION. ULTIMATELY, THE DESIGN AND DETAILING OF THE PROJECT, ASSEMBLY OR SYSTEM IS THE RESPONSIBILITY OF A PROFESSIONAL, AND ALL PROJECTS MUST COMPLY WITH APPLICABLE BUILDING CODES AND STANDARDS. GP GYPSUM DISCLAIMS ANY RESPONSIBILITY OR LIABILITY FOR THE USE OF THIS DRAWING AND FOR THE ARCHITECTURE, DESIGN, ENGINEERING OR WORKMANSHIP OF ANY PROJECT, ASSEMBLY OR SYSTEM. ANY PRODUCTS MANUFACTURED BY PERSONS OTHER THAN GEORGIA-PACIFIC GYPSUM ARE PRESENTED FOR ILLUSTRATION ONLY. PLEASE CONTACT THE MANUFACTURER OF SUCH PRODUCTS FOR INSTALLATION INSTRUCTIONS. GP GYPSUM MAKES NO REPRESENTATION OR WARRANTY, EXPRESS OR IMPLIED, CONCERNING THIS DRAWING AND SPECIFICALLY DISCLAIMS ANY IMPLIED WARRANTY OF FITNESS FOR A PARTICULAR USE.

Issued Date

10/16/2020

DLB-060.1